

DISCLAIMER: THIS STANDARD IS GOVERNED BY THE TEXAS ENGINEERING PRACTICE ACT. THE DESIGN REQUIREMENTS ON THIS STANDARD DO NOT PURPORT TO ADDRESS ALL OF THE SAFETY CONCERNS ASSOCIATED WITH THE USE OF THIS STANDARD. THE ENGINEER OF RECORD (EOR) IS TO REVIEW THESE DESIGN REQUIREMENTS AND BY AUTHORIZING THEIR USE, ACCEPTS RESPONSIBILITY FOR THEIR APPLICABILITY, ADEQUACY AND SAFETY. NO WARRANTY OF ANY KIND IS MADE BY THE CITY OF HOUSTON FOR ANY PURPOSES WHATSOEVER. THE CITY OF HOUSTON ASSUMES NO RESPONSIBILITY FOR INCORRECT RESULTS OR DAMAGES RESULTING FROM ITS USE.

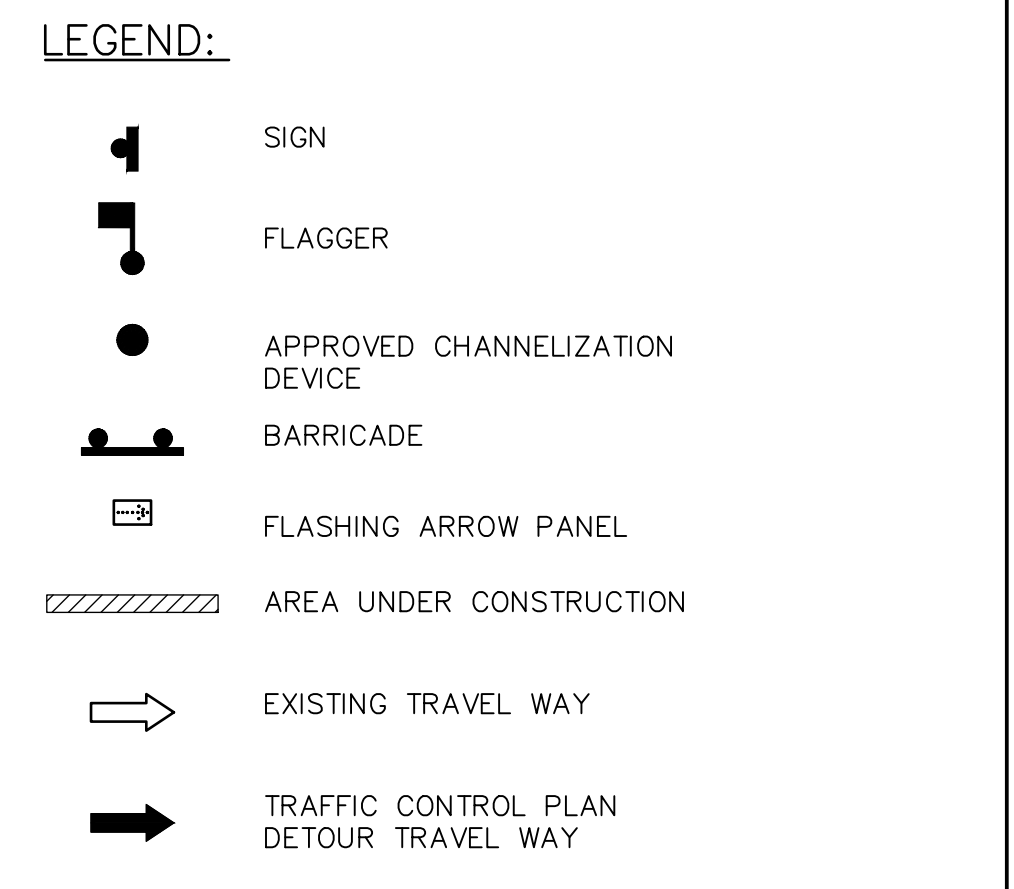

- NOTES:**
- MINOR WORK AND DAYTIME OPERATIONS ONLY.
 - REFER TO PROJECT SPECIFIC TRAFFIC CONTROL PLANS FOR MAJOR OPERATIONS AND OVERNIGHT LANE CLOSURES.
 - FOR DIMENSIONS REFER TO SHEET 01555-01.
 - INSTALL FLASHERS ON DRUMS WHERE REQUIRED AND APPROVED BY CITY TRAFFIC ENGINEER.
 - MAX. 100' WORK ZONE AT A TIME.

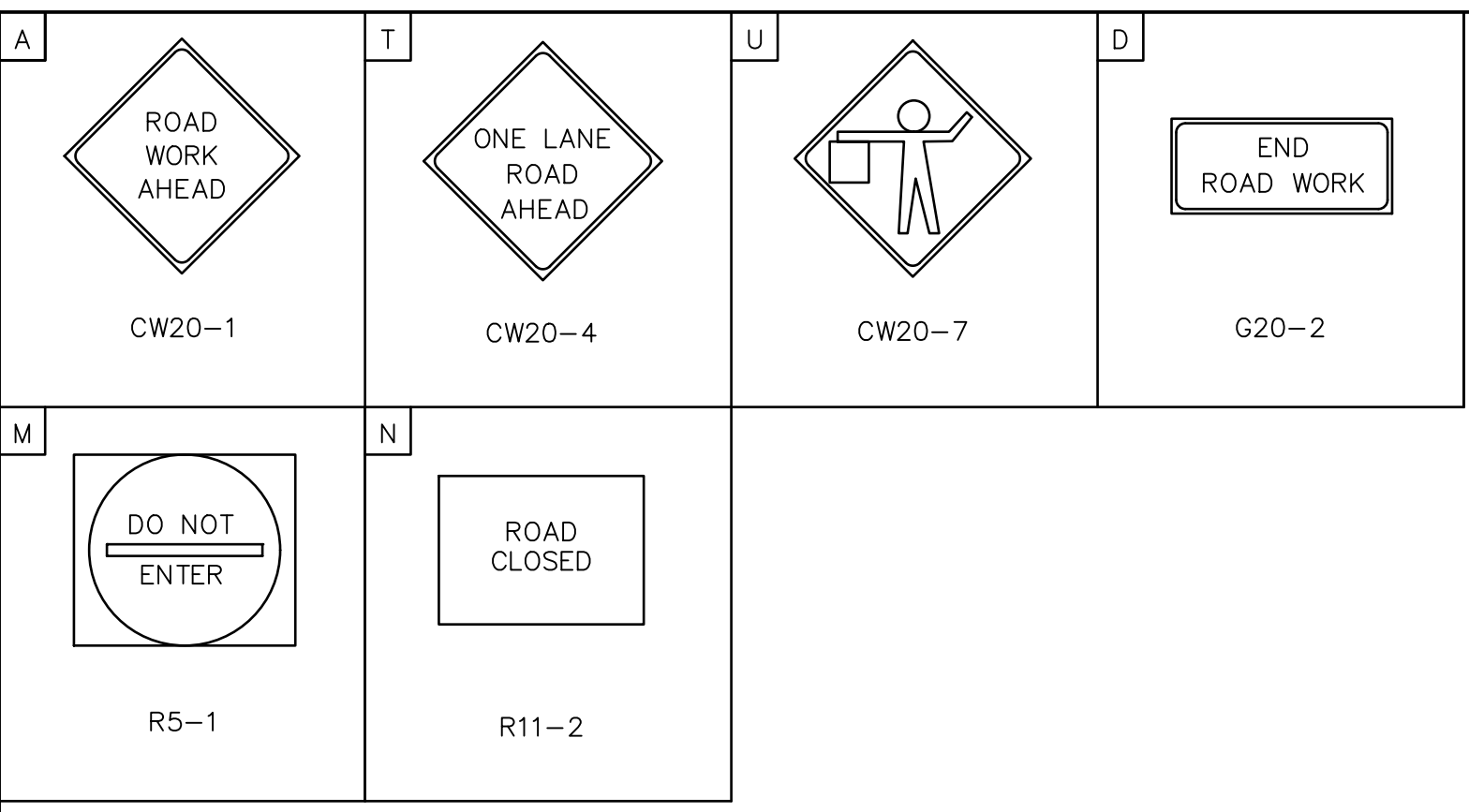
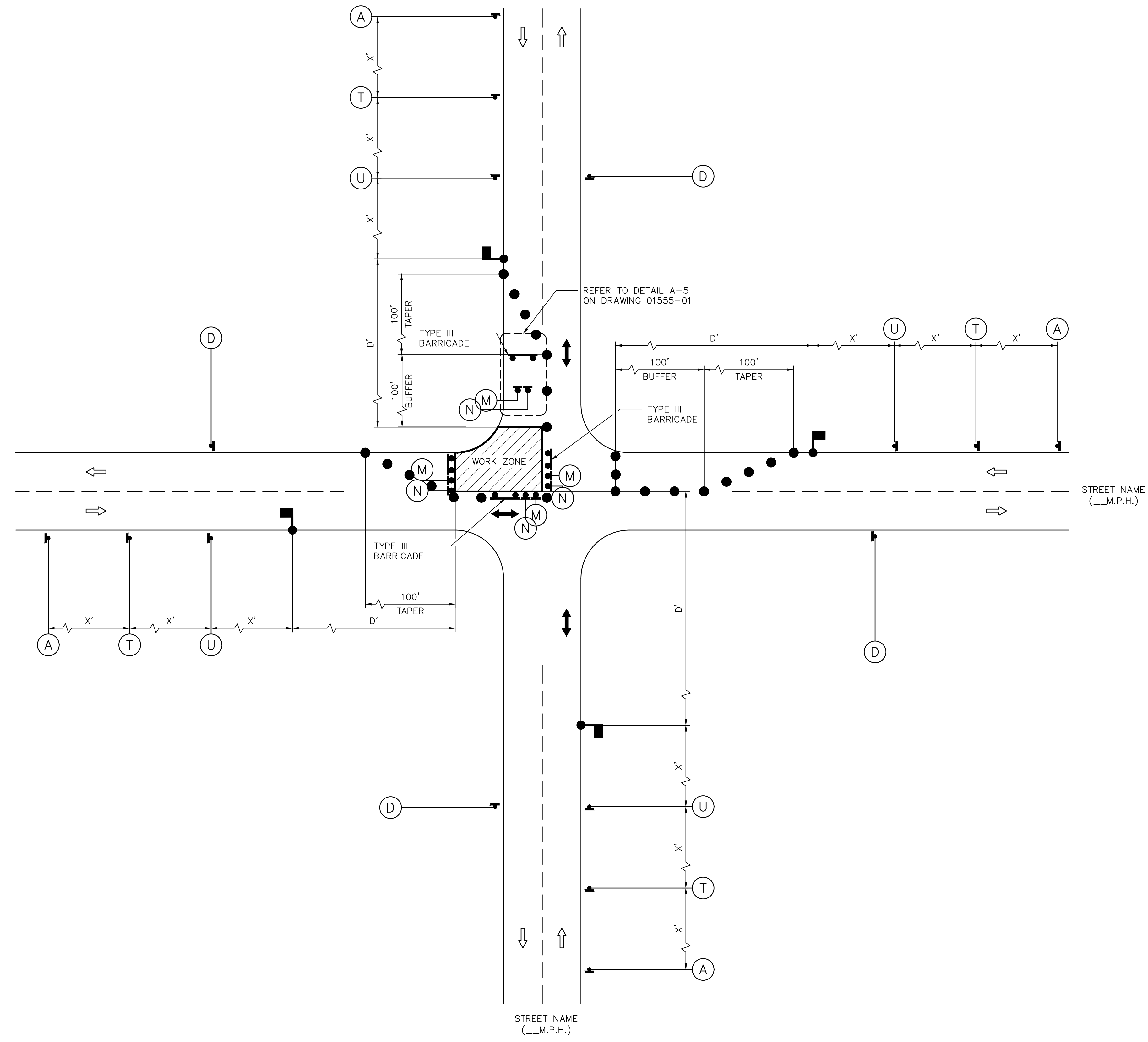

APPROVED BY: CITY ENGINEER	APPROVED BY: CITY TRAFFIC ENGINEER
APPROVED BY: DIRECTOR OF HOUSTON PUBLIC WORKS	
EFF DATE: NOV-27-2023	DWG NO: 01555-11
CITY OF HOUSTON HOUSTON PUBLIC WORKS STANDARD	
TCP TYPICAL CONSTRUCTION ZONE AT A 4-WAY INTERSECTION (LOW VOLUME TRAFFIC) PHASE 3 OF 4	
FOR CITY OF HOUSTON USE ONLY	
DRAWING SCALE	
NOT TO SCALE	