

1. For drainage, use a 4" perforated pipe as shown, or omit mortar from every other vertical joint In the first course above ground to drain in own property.

3. No surcharge load is allowed.

5. Minimum grout compressive strength = 2000 psi

6 Retaining walls 4'-0" or less in height, measured from the bottom of the footing to the top of the wall, are exempt from construction permits.

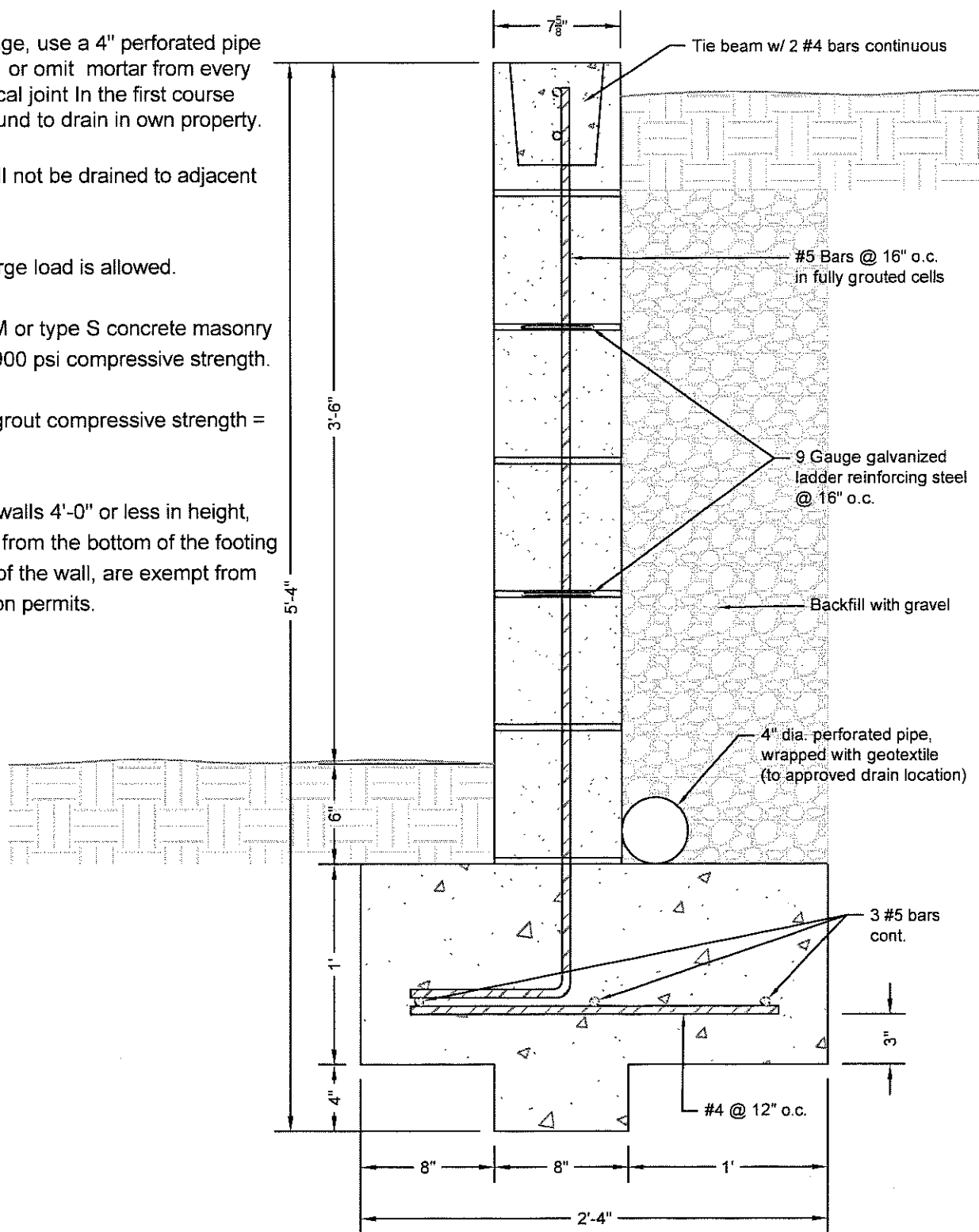

CITY OF HOUSTON
HOUSTON PUBLIC WORKS

SHORT RETAINING WALL

1002 WASHINGTON AVE., HOUSTON, TEXAS 77002

APPROVED BY:

BUILDING OFFICIAL

DATE: 7/7/2021

DWG No:
21-03-M

1 of 1