

SECTION  
DOWEL TYPE EXPANSION JOINT  
N.T.S.

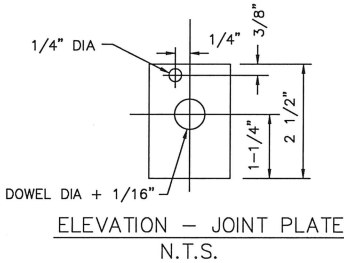

- NOTES:
1. STEEL TO MEET ASTM STANDARD SPECIFICATIONS FOR CONCRETE REINFORCING BARS.
  2. EXPANSION JOINT TO BE PLACED AT THE END OF EACH CURB RADIUS AND SPACED AT A MAXIMUM DISTANCE OF 3 FEET MAXIMUM SPACING FOR CONTROL JOINTS SHALL BE 5 FEET.
  3. CENTER DOWEL HORIZONTALLY ON JOINT.
  4. CENTER DOWEL VERTICALLY IN CONCRETE AS NEEDED TO MAINTAIN A 2 INCH MINIMUM COVER.

SIDEWALK EXPANSION AND CONSTRUCTION JOINT DETAILS  
NTS

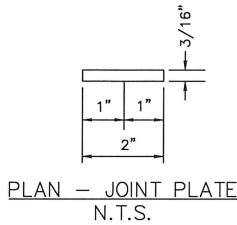
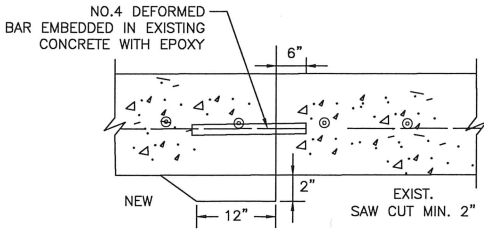

SECTION  
SIDEWALK TO EXISTING SIDEWALK  
N.T.S.

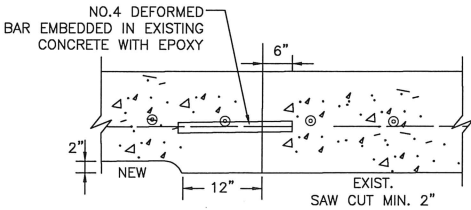

SECTION  
SIDEWALK TO EXISTING DRIVEWAY  
N.T.S.

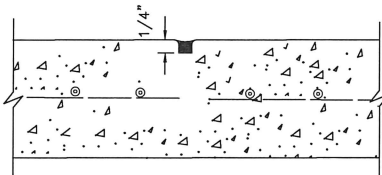

SECTION  
CONTROL JOINT  
N.T.S.

TABLE 1

PAVEMENT THICKNESS (IN)	DOWEL SIZES AND SPACINGS		
	DIAMETER (IN)	LENGTH (IN)	SPACING (IN)
4 1/2	1/2	18	12
5	1/2	18	12
6	3/4	18	12
7	1	18	12

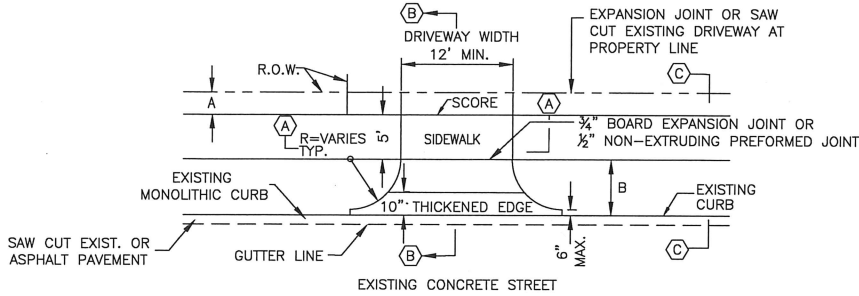

PLAN VIEW - DRIVEWAY

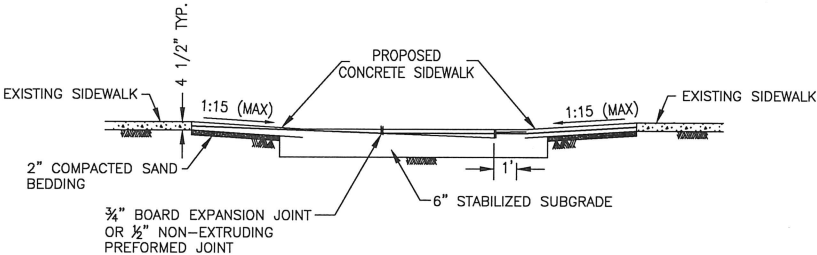

SECTION A  
PROPOSED SIDEWALK, THROUGH DRIVEWAY  
WITH EXCESSIVE GRADES  
N.T.S.

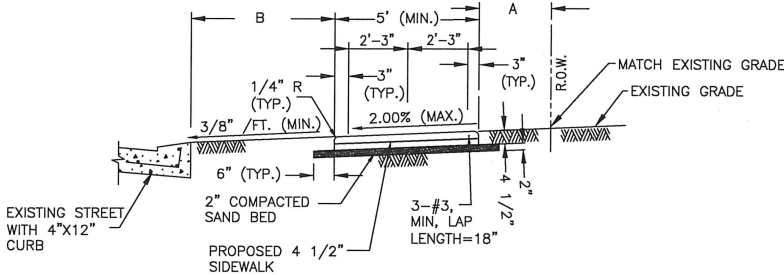

SECTION C  
TYPICAL SIDEWALKS SECTION  
N.T.S.

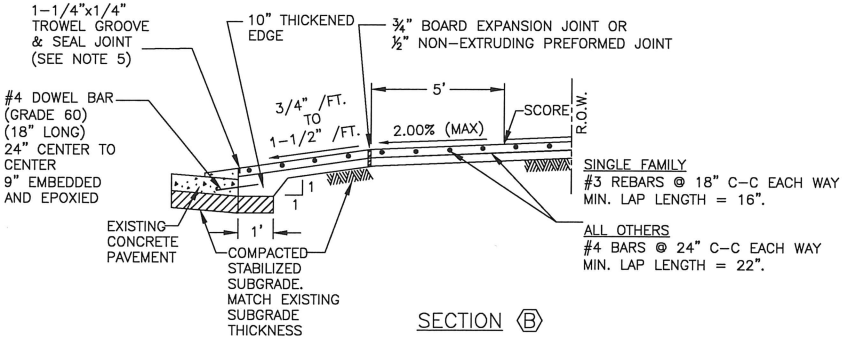

SECTION B  
TYPICAL DRIVEWAY SECTION  
N.T.S.

DRIVEWAY / LOCAL RESIDENTIAL STREETS  
NTS

- NOTES:
1. IF AVAILABLE ROW IS NOT SUFFICIENT TO ACCOMMODATE SIDEWALK WIDTH (SW) ACCORDING TO IDM REQUIREMENT, ENGINEER SHALL OBTAIN A VARIANCE FROM THE CITY ENGINEER.
  2. DRIVEWAYS SHALL BE 6" THICK FOR SINGLE FAMILY.
  3. DRIVEWAYS AND SIDEWALKS SHALL BE CONSTRUCTED WITH PORTLAND CEMENT CONCRETE AND INCLUDE 5 1/2 SACKS OF CEMENT PER CUBIC YARD OF CONCRETE.
  4. THE OUTER DOWEL BARS ARE TO BE LOCATED 12" FROM END OF PROPOSED EDGE OF DRIVEWAY RETURN. EXTEND DOWEL 3" INCHES INTO PROPOSED DRIVEWAY AND BEND REMAINING BAR TO EXTEND TO RADIUS RETURN BOTH SIDES.
  5. TROWEL GROOVE SEALANT SHALL BE LOW MODULUS SILICONE OR POLYURETHANE SEALANT.
  6. EXPANSION & CONSTRUCTION JOINTS ALONG SIDEWALK SHALL BE ACCORDING TO DRAWING No. 02752-02.
  7. REFER CHAPTER 17 DESIGN REQUIREMENTS FOR A AND B.
  8. CEMENT STABILIZED SAND 1.5 SACKS OF CEMENT PER TON OF DRY SAND.
  9. ALL RAMPS AND SIDEWALKS/WALKWAYS SHALL BE CONSTRUCTED IN ACCORDANCE WITH AGENCY STANDARD DETAILS, TEXAS ACCESSIBILITY STANDARDS (TAS) AND AMERICANS WITH DISABILITIES ACT (ADA) REQUIREMENTS. IF THERE IS A CONFLICT IN THE REQUIREMENTS, THE STRICTEST REQUIREMENTS SHALL GOVERN.
  10. CURB RAMPS THAT ARE STEEPER THAN A 1:15 MAX SLOPE WILL NOT BE ACCEPTED BY THE CITY OF HOUSTON

CITY OF HOUSTON  
HOUSTON PUBLIC WORKS

STREET PAVING AND SIDEWALK  
02752-02 THROUGH 02754-01A

APPROVED BY: [Signature] CITY ENGINEER  
APPROVED BY: [Signature] DEPUTY DIRECTOR

APPROVED BY: [Signature] DIRECTOR OF HOUSTON PUBLIC WORKS

EFFECTIVE DATE: JUL-01-2020  
FOR CITY OF HOUSTON USE ONLY

SHEET NO.