

DRIVEWAY GEOMETRICS

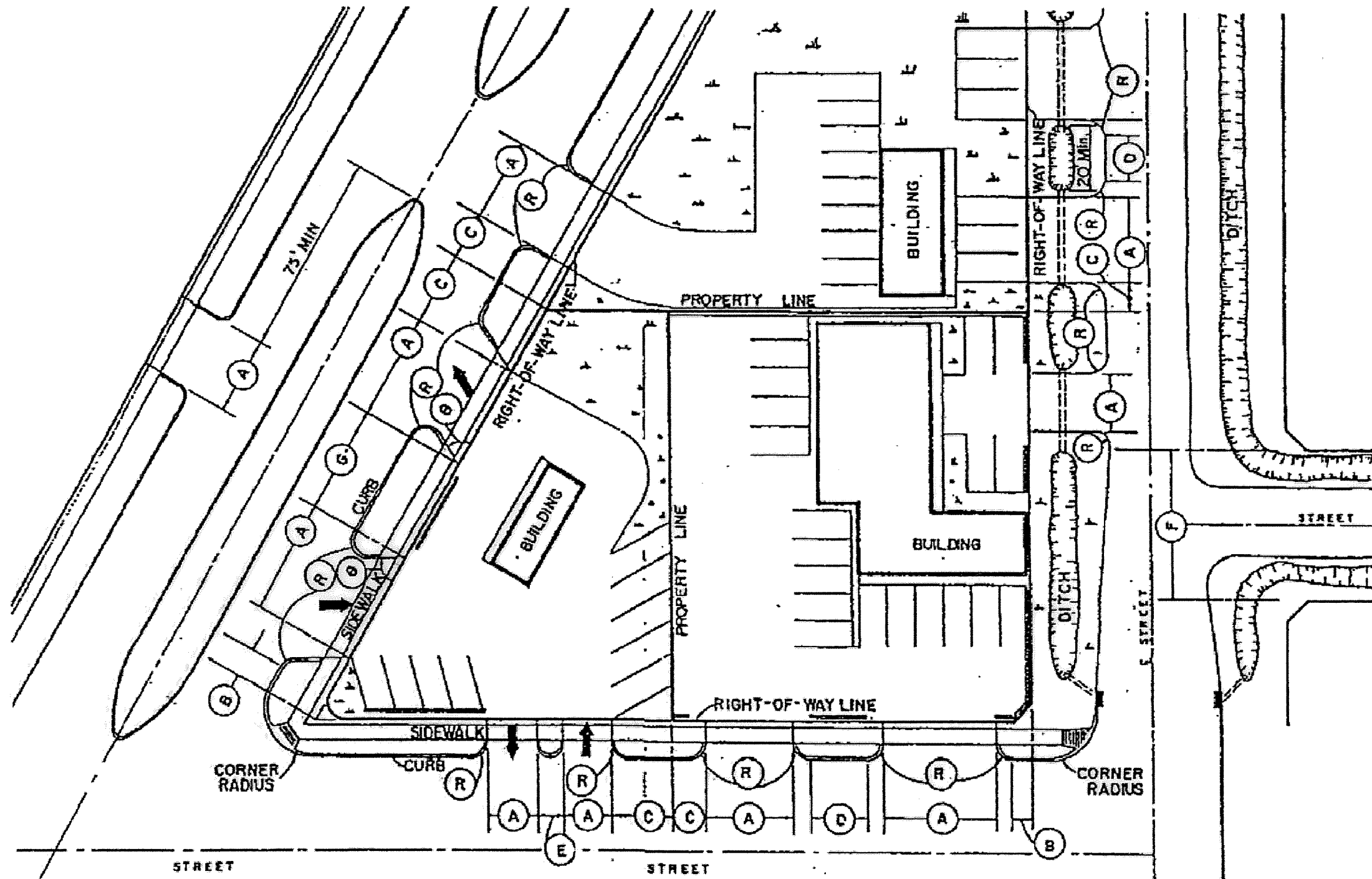

- A - DRIVEWAY
- B - CORNER R-O-W LINE (3)
- C - SIDE PROPERTY LINE (3)
- D - TWO-WAY (3)
- F - ONE-WAY (PERPENDICULAR)
- G - ONE-WAY (ANGULAR)
- R - DRIVEWAY RADIUS
- O - MINIMUM ANGLE (4)
- F - DRIVEWAY OPENING

CITY OF HOUSTON
DEPARTMENT OF PUBLIC WORKS AND ENGINEERING

SPACE REQUIREMENTS FOR
OFF STREET PARKING

(NOT TO SCALE)

APPROVED BY: <i>[Signature]</i>	APPROVED BY:
CITY ENGINEER	DIRECTOR OF PUBLIC WORKS AND ENGINEERING
EFF DATE: OCT-29-2015	DWG NO: 31-01